

---

**Local Impact Assessment Class 1 Application  
164 Monaro Street, Queanbeyan NSW**

**Queanbeyan Leagues Club Ltd (242285)**  
March 2013



## EXECUTIVE SUMMARY

### 1. INTRODUCTION

- i. This document is a Local Impact Assessment Class 1 to accompany a Threshold Increase Application made for approval of a 'low range' gaming machine threshold increase of 20 for Queanbeyan Leagues Club Ltd (the "Applicant") at premises situated at 164 Monaro Street, Queanbeyan NSW (the "Venue") located in the Band 2 Local Government Area (the "LGA") of Queanbeyan. The Applicant has operated at the Venue for 50 years and provides hospitality based recreational pursuits and community based enterprises for its members and their guests. This LIA provides relevant gaming data, social data and issues of concern to the Local Community so that the Authority can determine whether additional gaming machines will positively contribute to the Local Community.

### 2. RESPONSIBLE GAMBLING MEASURES

- ii. Chapter 2 of this Report details the mandatory and additional responsible conduct of gambling measures put in place by the Applicant at the Venue. The Applicant operates its gaming machine operations in strict accordance with legislated and 'best-practice' interventions and initiatives modelled on its Responsible Service of Gambling House Policy (see Appendix 1). The Applicant has also implemented additional measures to ensure compliance with recent amendments to the Gaming Machines Act 2001 and associated Regulations. The Applicant is a member of ClubSafe, and has adopted its best practice guidelines and policies.

### 3. LOCAL COMMUNITY

- iii. Chapter 3 of this Report details the communities potentially affected by the approval of the Application. The Queanbeyan LGA is the Local Government Area of the Venue and a map illustrating the extent of the LGA and the location of the Venue is included as Appendix 3. An area extending 5kms from the Venue has been identified as the Local Community for the purpose of assessment. Chapter 4 provides a demographic description of the LGA and Local Community.

### 4. POSITIVE CONTRIBUTION

- iv. Chapter 5 of this Report details the positive contribution resultant from approval of the Application to the Local Community. If the Application is granted, a donation of \$120,000 will be made to Queanbeyan City Council towards the refurbishment and expansion of Railway Park Skate Park, located on the corner of Henderson and Ross Roads, Crestwood. The project will involve the addition of further hard surface areas with street skate features, additional seating, shelter, landscaping and the general beautification of the existing facilities. Railway Park Skate Park is located in one of the fastest growing parts of Queanbeyan. Its improvement directly responds to one of the key priorities outlined in *Queanbeyan Tomorrow – Community Vision 2021* – the provision of recreational opportunities for youth.

### 5. CONCLUSION

- v. Given the satisfaction of the requirements of the Act and Regulation through the conduct of gaming machine operation at the Venue in a responsible manner and the evidence of substantial positive contributions to the Local Community, it is the Applicant's belief that this LIA meets the requirements of the Legislation.

## **1 INTRODUCTION**

1.1 This Report is a Local Impact Assessment ("LIA") Class 1 to accompany a Threshold Increase Application for a Band 2 Local Government Area venue of 'low range increase' of 20 gaming machines for Queanbeyan Leagues Club Ltd ("the Applicant"). The Applicant is located at 164 Monaro Street, Queanbeyan NSW ("the Venue") in the Queanbeyan Local Government Area ("the LGA").

### **1.2 Methodology**

1.3 In respect of LIAs relating to threshold increase applications, the LIA Guidelines provide that the Casino, Liquor and Gaming Control Authority ("the Authority") can only approve an LIA where the LIA complies with the requirements of the [Gaming Machines] Act [2001] and the [Gaming Machines] Regulations [2008] ("the Legislation") and demonstrates that gambling activities will be conducted in a responsible manner. The Guidelines further state that an LIA Class 1 must demonstrate that the proposed increase in gaming machines for the venue will provide a positive contribution towards the Local Community in which the venue is situated.

### **1.4 Applicant Details and History**

1.5 The Applicant, founded in 1963, was established in order to promote and support the development of rugby league in the area. The Venue was destroyed by fire in 1972 and was subsequently rebuilt, since this time it has had four renovations, with its most recent redevelopment and refurbishment having been completed in 2005. The Applicant has now grown to over 13,000 members and employs 81 staff on a full time, part time and casual basis. The Applicant is a major sponsor of the Canberra Raiders Rugby League team and is the local area's major contributor to rugby league and sport in general.

### **1.6 Current Applicant Services, Facilities and Donations**

1.7 The Venue includes a bar, Blue q Café, alfresco terrace areas and gaming and wagering facilities, as well as function and meeting rooms. The Applicant provides donations to a number of organisations throughout the local community including Queanbeyan Public School, Queanbeyan Gift, ACT Eden Monaro Cancer Support Group, Queanbeyan Men's Shed, Queanbeyan City Rural Fire Brigade, Men of League Foundation, Queanbeyan Multilingual Centre and the Lions Club of Queanbeyan, donating \$801,848 by way of the ClubGrants scheme in 2012. The Applicant has a particular commitment to supporting local sporting groups. As well as being a major sponsor of the Canberra Raiders, the Applicant is the primary sponsor of Queanbeyan Leagues Swimming Club and Queanbeyan United Hockey Club, amongst others. The Applicant is part of the Canberra Raiders Group, which is comprised of seven registered clubs across the ACT/NSW and an additional two in southern Queensland.

1.8 **Financial performance of the Applicant**

- 1.9 The Applicant had a total revenue in 2012 of \$27.4 million and a pre-tax profit of \$2.5 million. Gaming machine revenue for the year ending October 2012 was \$21.8 million, representing approximately 79.4% of total revenue. The Applicant paid \$5.4 million in gaming machine duty in 2012. The Applicant made donations of \$801,848 in 2012, and had a total employee benefits expense of \$4.3 million.

1.10 **Gaming machine indicators**

- 1.11 The Applicant operates 353 gaming machines currently. The Applicant had a profit per gaming machine (total turnover less payouts) of approximately \$61,739 for the 2012 year. The average net profit per gaming machine for Queanbeyan LGA in 2012 was \$56,710. The Applicant projects that each additional gaming machine will return a profit of approximately \$40,000 per annum. The additional machines will thus add an estimated \$800,000 for the first year of operation to the gaming revenue of the Applicant.

1.12 **Proposal**

- 1.13 The Applicant has committed to donating \$120,000 towards the improvement and extension of Railway Park Skate Park, located on the corner of Henderson and Ross Roads, Crestwood. The facilities are geared towards both advanced and beginner skateboarders, and also accommodate those using BMXs, rollerblades and scooters. The planned refurbishment will involve the addition of further hard surface areas with street skate features, additional seating, shelter, landscaping and the general beautification of the existing facilities. The refurbishment project answers the Local Community's call for the provision of recreational opportunities for its young people, as is documented in *Queanbeyan Tomorrow – Community Vision 2021* and *Queanbeyan City Council: Community Strategic Plan 2010-2020*. Australian Bureau of Statistics data also demonstrates that Queanbeyan's youth comprise a significant proportion of its population.
- 1.14 Further detail in relation to the positive contributions is provided later in this Report.

## **2 RESPONSIBLE GAMBLING MEASURES**

- 2.1 The Applicant's gaming machine operation is in strict accordance with legislated and optional responsible gambling measures and is considered best practice in this area. A copy of the Applicant's House Policy on the Responsible Conduct of Gambling is included at Appendix 1. The Applicant operates its responsible gambling house policy which is drafted in accordance with the legislative requirements stated in the Gambling Legislation Amendment (Responsible Gambling) Act 1999, the Registered Clubs Act 1976, the Gaming Machines Act 2001 and accompanying regulations. The Applicant's harm minimisation strategies are extensive. A full list is attached as Appendix 2.
- 2.2 The Applicant is a member of ClubSafe, and has adopted the best practice guidelines and policies suggested by each of these organisations. As such, the Applicant goes beyond compliance with current legislation.

- 2.3 The Applicant only recently expanded its self-exclusion offering, so that it now offers the ClubSafe online self-exclusion program. This gives patrons the ability to self-exclude from all local venues within a particular area. The program also allows for the provision of updates from other clubs in the region, making the Applicant's self-exclusion scheme much more accessible and effective.

### **3 LOCAL COMMUNITY**

#### **3.1 Definition of Local Community**

- 3.2 The Legislation provides that there must be a positive contribution from approval of the Threshold Increase Application. The methodology which the Applicant has used to define its Local Community has been developed through its analysis of its membership penetration in the surrounding area. Generally a registered club will have a membership penetration in urban and semi-urban areas of approximately 5kms. This assessment is linked heavily to legislative requirements pertaining to compulsory membership of any person residing within 5kms of the registered club in question. . In the context of the information set out above, the Local Community is defined as encompassing:

The following suburbs: *Crestwood, Dodsworth, Karabar, Letchworth, Oaks Estate and Queanbeyan*; and

Parts of the following suburbs: *Fyshwick, Googong, Greenleigh, Hume, Jerrabomberra, Pialligo and Symonston*.

- 3.3 The Local Community is defined as per the map attached as Appendix 4. It is submitted that this defined area meets the requirements of the Act, Regulation and Guidelines.

### **4 DEMOGRAPHY**

- 4.1 Queanbeyan LGA is located in southern NSW, on the eastern border of the ACT, about 12 km south-east of Canberra and about 250km south-west of Sydney. The LGA is bounded by the ACT to the north and west, and Palerang LGA in the east and south. Covering an area of approximately 173km<sup>2</sup>, the LGA is predominately rural, with expanding residential areas, particularly in the north-west, close to Canberra. It comprises approximately 15,307 private dwellings and is a sub-region of the Queanbeyan Statistical Sub-Division. In August 2011, its population was estimated at 39,826. In 2011 75.8% of the population were aged 18 years and over. This compares to 76.9% for NSW at the same period. The median age of people residing in the LGA in 2006 was 35 years, significantly younger than the state median of 38 years. 75.9% of the population is Australian-born. The population of the Queanbeyan LGA grew by 5.6% between 2006 and 2011. This figure is on par with the population growth experienced state-wide between the 2006 and 2011 Censuses, which also occurred at a rate of 5.6%.

- 4.2 In August 2011, the rate of unemployment in the Queanbeyan LGA was estimated at 2.9%, significantly lower than the NSW rate of 5.9%. Queanbeyan LGA has a SEIFA (2006 social-economic index of relative advantage-disadvantage) of 1041, which is higher than the State average of 978. An alternative measure of SEIFA is provided by the ABS. Each LGA in NSW has been ranked in deciles (ranges of 10 percent). The first decile denotes the most disadvantaged LGAs, the tenth decile, the most advantaged. Queanbeyan LGA falls in the ninth decile. It therefore ranks close to the top of all NSW LGAs. The advantage of using this method to analyse SEIFA is that it allows comparison with all LGAs, not simply a State average, which is skewed by a small number of very high SEIFA estimates for certain LGAs. This is emphasised by the fact that in 2006 only 50 of 151 LGAs (excluding Unincorporated NSW) or 33.1% of all LGAs, had a SEIFA in excess of the NSW average.
- 4.3 The LGA is characterised by its relatively young population, as evidenced by its median age of 35, compared to 38 for NSW. The proportion of the population aged less than 18 years is relatively high at 24.2%, compared to the NSW figure of 23.1%.
- 4.4 The LGA is experiencing significant population growth given its proximity to the major employment sector of Canberra and access to major transport links. Projections indicate that Queanbeyan's population will increase to 56,953 in 2026 – that is, by a very significant 43% over a 25 year period. This growth will be spearheaded by the greenfield sites located within the suburbs of Googong and Tralee, which is expected to see average annual rates of growth of 9.26% and 14.33% respectively.
- 4.5 The LGA is characterised as one of the more affluent regional areas in Australia, currently experiencing considerable prosperity in connection with its proximity to Canberra. Demographic indicators provide evidence for this view, with unemployment very low at 2.9% and the median household income of \$1,657, significantly higher than the State average of \$1,237.
- 4.6 Demographic markers pertaining to the Local Community position it as similar in character to the LGA.

## **5 POSITIVE CONTRIBUTIONS**

- 5.1 The granting of the Application will yield significant benefits for the Local Community and LGA in the form of the refurbishment and expansion of Railway Park Skate Park, a project which will be facilitated by Queanbeyan City Council and partially funded by the Applicant.
- 5.2 **Railway Park Skate Park**
- 5.3 Railway Park Skate Park ('RPS') is located on the corner of Henderson and Ross Roads, Crestwood. Crestwood is a suburb of Queanbeyan, located to the west of Queanbeyan itself. RPS is in very close proximity to Queanbeyan Railway Station, making it easily accessible via public transport.
- 5.4 RPS has a triangular street layout, and features flat banks, rails, a ramped hip, ledges, grind boxes with metal edges and a ramped kicker extruding from a flat bank. It is aimed at both beginner and more advanced skateboarders, and is also suitable for users of BMX, rollerblades



and scooters. It is currently in a somewhat dilapidated state, and would significantly benefit from the planned refurbishment.

5.5 **The project**

5.6 The refurbishment and extension project will include the following:

- Additional hard surface comprising street skate features;
- Seating;
- Shelter;
- Landscaping; and
- Beautification of existing skateboarding and family-friendly facilities.

5.7 The improvement of RPS is intended to render it more aesthetically appealing to users, more functional, safer and more family-friendly. The overall aim is that more people will use RPS and use it more frequently, and that users will experience a higher degree of satisfaction.

5.8 **Funding**

5.9 The Applicant has promised to partially fund the refurbishment and expansion project. It will donate a total of \$120,000. A letter outlining the donation is included as Appendix 6.

5.10 **Evidence of a particular need within the Queanbeyan LGA**

5.11 The Queanbeyan LGA is notable for its relative youth, which is evidenced by its median age of 35 – much lower than the median age of 41 for regional NSW, and lower than the state-wide median age of 38 – along with the comparatively high proportion of residents aged less than 18 years, which was 24.2% in 2011. In fact, Queanbeyan has more children across all age groups when compared to the NSW average. Council documents support this characterisation of the area as predominately youthful, and also observe the LGAs rapid population growth. Projections indicate that Queanbeyan's population will increase to 56,953 in 2026 – that is, by a very significant 43% over a 25 year period. Indeed, the suburb within which RPS is located, Crestwood, saw its population increase by a sizeable 9.5% between 2006 and 2011. LGAs that experience such speedy increases in population density typically do struggle to maintain appropriate levels of both hard and soft infrastructure, including recreational facilities.

5.12 In conjunction with Australian Bureau of Statistics data, various Queanbeyan City Council documents suggest the extent to which the improvement of RPS will benefit the Local Community and the LGA. *Queanbeyan Tomorrow – Community Vision 2021* asserts a number of strategic priorities and associated key directions and strategies (p. 5), many of which support the funding of the RPS enhancement project. Those that are of relevance to the Application are excerpted below:

Strategic Priorities	Key Directions and Strategies
Image and Influence	"Places that are important to the community"
Culture and Leisure	"Excellence in recreation and lifestyle opportunities"
Infrastructure, Access and Transport	"Planning for future growth"
The Community	"Providing services"

5.13 *Queanbeyan Tomorrow* goes on to list a number of key themes raised during both the 2006 and 2011 community consultation processes (p. 10) in response to queries as to how residents imagined Queanbeyan's future and what they thought could be done to achieve the type of regional city they ideally envisioned. Again, those of relevance are listed below:

- The CBD – youth activities;
- Services – recreation (note that this was the first of the service types listed, followed by social, health, aged care and schools);
- Culture – social activities; and
- Infrastructure – planning for and managing future growth.

5.14 Central to this Application is the strategic priority entitled 'Culture and Leisure'. If Queanbeyan were to realise the hopes of its current residents, in 2021 it would offer a lively and diverse range of cultural and leisure opportunities, as imagined below:

*There is wonderful participation in a range of social, leisure and cultural activities across all age groups, abilities and interests. Queanbeyan has continued its strong and active participation in sports, and has built on its activities and facilities for recreation and arts. Supporting the community's diverse lifestyles will be a **wide array of leisure, recreation, arts, cultural, sporting and entertainment facilities which are accessible, affordable and available** (p. 12, emphasis added).*

5.15 In terms of the social outcomes listed within *Queanbeyan Tomorrow*, those that are of most relevance are as follows:

*"Appropriate, quality community services and facilities are available to the community."*

*"People [...] of all ages, backgrounds and abilities are celebrated, supported and encouraged to live, work and play in Queanbeyan." (p.53).*

5.16 ***Queanbeyan City Council: Community Strategic Plan 2010-2020*** similarly supports the contention that the improvement of RPS will be of value to the Queanbeyan LGA. The Queanbeyan Community Satisfaction Survey 2008, upon which this document is based, identified the need for more facilities directed at Queanbeyan's youth. Priority 4.5 –



‘Creating opportunities for youth’ – listed the provision of “recreational opportunities for young residents” as its ultimate outcome.

- 5.17 Another noteworthy section of the *Strategic Plan* is the “Commentary on Resourcing Requirements”, which explains that “over the years Queanbeyan City Council has not been sufficiently funding its maintenance and renewal programs” (p. 30). As a result, there is a significant backlog of required maintenance works. It is apparent, then, that Council is in desperate need of funding support if it is to be able to properly maintain its many leisure facilities, including RPS.
- 5.18 In addition to the abovementioned documents that represent the Queanbeyan community’s concerns and requirements in terms of leisure, facility maintenance and opportunities for youth, by way of resolution 0249/12, in 2012 Queanbeyan City Council specifically undertook to “include in [its] priority list [...] the Henderson Road Recreation and Skate area”.
- 5.19 In summary, Council documents and Australian Bureau of Statistics data indicate the following:
- That there is a significant overrepresentation of youth in Queanbeyan;
  - That Queanbeyan is a rapidly growing LGA, including, in particular, the suburb of Crestwood, within which RPS is situated;
  - That the provision of accessible and affordable leisure and cultural facilities is a top priority for Queanbeyan City Council; and
  - That the provision of recreational opportunities for Queanbeyan’s youth is of particular importance.
- 5.20 **How do skate parks benefit the communities within which they are located?**
- 5.21 The average skate park user is a 15 year old male, with the majority of users being males aged between eight and 24 years of age. However, skate parks are not limited to this particular sector of the population – users can be anywhere between five and 50 years, and both statistical and anecdotal evidence suggests that there is a growing number of females choosing to participate in skateboarding and biking activities at such venues across Australia. The population of Queanbeyan is aptly suited to this type of facility, given the area’s sizeable proportion of young people.
- 5.22 The 2008 publication, *Skaters’ Paradise: A Study of Gold Coast City Skate Parks and Their Users*, co-authored by Graham Bradley of Griffith University and Kiri Stinson of Gold Coast, provides a great deal of insight into the way skateboarders use skate parks and the types of benefits such facilities can provide in a local sense. The following benefits are listed as potentially stemming from the construction and upkeep of a modern skate park within a suitable Australian locality:
- 5.23 ***An alternative physical activity for youth who are not attracted to traditional team sports***

- 5.24 Children and young adults who are uninterested in or do not possess the skill, strength or coordination required to participate in traditional team sports such as football or cricket are at risk of exclusion from physical activity altogether. Skate parks provide an alternative to these sports. Skateboarding and BMX riding can be undertaken as sole pursuits, or can involve the same type of camaraderie as do team sports. Like other sports, these also require practice and the development of a set of specific skills. Participation in skateboarding has similar outcomes too – increased fitness, expending of energy, self-esteem building, the ability to set and achieve goals, and the development of friendships. As Tony Hawk Foundation explains:

*Providing recreational opportunities to young children helps them to develop healthy, active lifestyles [...] Developing a habitual desire for physical recreation is essential to a healthy future (<http://www.tonyhawkfoundation.org>).*

- 5.25 In regional areas of NSW in particular, where rugby league and cricket tend to have such a stronghold over the community, the provision of alternative sporting facilities is very important so as to meet the needs of as many of the local youth as possible.

- 5.26 ***A leisure pursuit that keeps young people busy and helps to prevent the commission of crimes***

- 5.27 It is widely documented that young people who engage in antisocial and criminal activity often do so in connection with boredom. Youth boredom is one of the key challenges faced by regional communities, and Queanbeyan City Council's call for additional and better recreational facilities aimed at youth suggests that boredom is an issue for young people residing in the Queanbeyan LGA. Skate parks provide recreation for both the skateboarders themselves and spectators, and function as a social hub and meeting place for youth. RPS is accessible to Queanbeyan's young people both in the fact that there is no cost to users and due its proximity to Queanbeyan Railway Station.

- 5.28 *Skater's Paradise* also notes how perfectly suited skate parks are to their adolescent users:

*Because parks permit unsupervised, unstructured, peer-centred activities, they are likely to satisfy adolescents' need for autonomy and affiliation, and they provide opportunities for young people to develop social skills related to co-operation, turn-taking and conflict resolution (p.4).*

- 5.29 ***A means of developing skills and improving balance, co-ordination and concentration***

- 5.30 As Tony Hawk Foundation explains, "skateboarding is physically active and requires, at times, great concentration. It encourages [youth] to spend time outdoors, tests their endurance, sharpens their senses and develops their creativity". Skate parks offer safe, sanctioned spaces within which skateboarders are free to practice their tricks, without disturbing or endangering others.

- 5.31 *Skater's Paradise* also details this particular benefit, noting that "skate parks facilitate the development of balance and coordination, as well as more specific skating skills". Such skills can be linked to "gaining acceptance, self-esteem and confidence in [one's own] ability" (p.20).
- 5.32 The benefits of maintaining RPS are evidently numerous, and its upkeep is in direct response to Queanbeyan City Council's prioritisation of the provision of youth-centred recreational facilities. ABS data supports the significance of Queanbeyan LGA's young population.
- 5.33 It is submitted that the Applicant's plan to partially fund the improvement of RPS will be of significant benefit to its Local Community and Queanbeyan LGA as a whole, given the region's overrepresentation of young people and the consequent need for well-appointed and accessible recreational facilities aimed at youth.

## 6 CONCLUSION

- 6.1 This LIA, pursuant to Section 37 of the *Gaming Machines Amendment Regulation* 2009, defines the Applicant's Local Community, details the positive contributions that the Applicant will provide to the Local Community if the Application is approved, and details the harm minimisation and responsible gambling measures that are in place at the Venue.
- 6.2 The Applicant is a community based registered club which provides needed community support through additional donations exceeding those required through ClubGrants contributions. The Venue provides a central meeting place for its Local Community, including numerous recreational and social facilities and opportunities existing for the benefit of members and guests.
- 6.3 The Applicant operates gaming at the Venue in compliance with mandated legislative requirements and operates a best-practice style of interventions and procedures. The Applicant enforces this strict approach based on its House Policy on the Responsible Conduct of Gambling conducting regular in-house training for all of its gaming staff, each of whom holds qualifications in the Responsible Conduct of Gambling.
- 6.4 The positive contribution put forward in this LIA will not occur without the approval of the Application. The Applicant has pledged \$120,000 towards the refurbishment and extension of Railway Park Skate Park. Demographic data and Council documents demonstrate the need for this type of service in the Queanbeyan LGA, which has a markedly youthful population.
- 6.5 It is therefore provided that the test as set out in the Guidelines and Legislation is met and the Applicant submits that the Threshold Increase Application should be approved.

## Appendix 1

### ClubSafe Responsible Conduct of Gambling Policy

---

---

Prepared by:



© Lawler Partners Pty Ltd 2013. Reproduction or copy of this document, or part thereof is prohibited except as where expressly permitted under the Copyright Act 1968 or where written permission is provided from Lawler Partners Pty Ltd.

---



# IMPORTANT NOTICE

## Machine Playing Conditions



**These Conditions regulate and limit the rights and obligations of anyone who plays a gaming machine in the Club.**

**You should read them before playing any machine. Do not play any machine if you do not understand and accept all of these Conditions.**

1. No patron is required to participate. Any playing of machines is at your sole option, discretion and risk.
2. Player information brochures are available. Please ask if you would like to know how to get one. Player brochures are for general information only and if there is any inconsistency with these Conditions, then to the extent of the inconsistency these conditions prevail.
3. You should not play any machine unless you completely understand -
  - (a) how you have to play it, and
  - (b) the combinations that you would have to get to win a prize.
4. If you disagree with anything done by the Club in connection with a prize or the playing of a machine, please ask about the Club's complaint handling procedures.
5. Machines must not be played by anyone under the age of 18 years.
6. These Conditions cannot be varied for you personally except by a document that sets out the change(s), expressly refers to these Conditions and is signed by an authorised Club officer.
7. These Conditions apply even where there are separate conditions stipulated for a particular machine or promotion or prize, except only where (and to the extent that) the Club expressly states in writing that it is amending these Conditions.
8. Payment may be withheld and the Police called if in the Club's opinion a machine or the circumstances show any sign of use of or interference with the machine which is unlawful or in breach of these Conditions or the Club has any reasonable suspicion of play in breach of these Conditions or which is otherwise improper.
9. A prize or purported prize will not be paid or awarded where in the Club's reasonable opinion it arises as a result of a machine malfunction; or as a result of any aspect of the operation, working, use or performance of the machine that was not intended or not reasonably anticipated by the Club (even if that aspect of the operation, working, use or performance of the machine was otherwise predictable); or (without limiting the previous general words), where the winning combination showing has not been registered in the machine. The Club's decision is final.
10. Various legal requirements binding on the Club in some circumstances are mandatory and cannot be varied. If any such requirement is inconsistent with these Conditions then the legal requirement prevails but only to the extent of the inconsistency.
11. You must not play any machine which the Club has marked as malfunctioning or otherwise in some way marked or indicated as withdrawn from play. The Club will not pay any prize won on any such machine.
12. At any time when requested by the Club a player must provide their full name and address plus details of the basis on which they are on the Club's premises, with such documentary proof as the Club reasonably requires. The Club may prevent you from playing or continuing to play any machine if you do not satisfactorily comply with this requirement.
13. Club employees and former employees, and contractors and suppliers to the Club (and their officers and staff) must observe all relevant restrictions imposed by the Club from time to time regarding such persons. Without limiting those general words, an employee must not play machines whilst on duty nor during meal or rest periods or other breaks from duty. Prizes won by an employee or former employee, or by a contractor or supplier (or one of their officers or staff) when playing a machine in breach of this Condition, will not be awarded or paid.
14. Only coins and notes of Australian legal tender are to be used to play gaming machines and that must be in accordance with the particular requirements of any particular machine as noted on that machine.
15. You may reserve not more than one machine at a time and then for a maximum of 15 minutes. However, the Club may in any particular case decide in its discretion not to allow a machine reservation to continue. The Club has no liability to you if you reserve a machine but for any reason that machine is played by some other person. The Club may in its discretion but without limiting the other provisions of this condition, allow particular types of players to reserve more than one machine or to reserve a machine for a longer period.
16. The Club may reserve any number of machines for the exclusive use of full members or for a particular promotion or activity. If you are not entitled to play a machine under any such particular arrangement then you are not entitled to claim any prize won on the machine whilst it is so reserved.
17. A prize will not be paid unless the winning combination is seen by an authorised staff member of the Club and verified for payment according to the Club's standard procedure for paying prizes.
18. A prize will not be paid if it is won before the opening time of the Club, or after the announced closing time of the Club.
19. The Club has the right to ensure that every prize, short pay and machine refill is played off.
20. The Club may refuse any person the right to play or to continue to play a gaming machine in its discretion at any time without giving any reason.
21. You must immediately report to an authorised Club staff member, any machine that is able to be operated without using the correct legal tender or without reducing the credit meter by an appropriate amount or that is malfunctioning in any other way, and you must stop playing that machine.
22. You must also immediately report to an authorised Club staff member, any machine that overpays or pays other than the correct amount for a winning combination, and you must stop playing that machine.
23. Any property, including money, left by players in or on an unattended machine must be reported and returned to the Club for appropriate action.
24. If you do not report a malfunction as required then you may be liable to the Club for damages suffered by the Club as a result.
25. You must not tilt, rock, move damage or interfere with a machine or do anything calculated or likely to interfere with the normal operation of a machine, or do anything prohibited by law.
26. Cheating in relation to a machine is a very serious criminal offence carrying a maximum penalty of \$11,000.00 or imprisonment for 12 months, or both, for each offence.
27. Prizes are not payable to any player, and may not be claimed by any person, who is under the age of 18 years or who is not either a financial member, provisional member, temporary member or honorary member, or a bona fide guest of a member and on the premises in compliance with all requirements of the law and the Club's Constitution and playing the machine in the reasonable company of the member concerned.
28. Prizes or accumulated credits over \$2,000.00 will, and prizes of less than that amount may be paid by crossed cheque payable to the prizewinner, or by EFT where that is requested by the prizewinner and those means are available to the Club.
29. Monetary prizes and stored or accumulated credits will be paid within 48 hours of a request for payment from the prizewinner. The Club in its discretion may pay part of a prize or of a stored or accumulated credits, in advance of paying the balance.
30. A prize may be awarded in a non-monetary form. Where a prize is awarded in a non-monetary form there is no option to take the prize in any other non-monetary form except as the Club may have separately specified in writing for any particular machine or promotion. The prizewinner does have the choice of being paid instead. The prize will be awarded as stated in the Club's published information, or if no time has been specified then within 48 hours of a request from the prizewinner.
31. Where a prize is not awarded or paid immediately after the prizewinner has requested it, the Club will give the prizewinner a written acknowledgment of the prizewinner's entitlement to the prize.
32. For a monetary prize, the Club will pay the prizewinner an amount equal to but not exceeding the value of the credits accumulated by the prizewinner from playing the relevant machine.
33. Except as specified by the Club in writing or by legislation for any particular machine or promotion, all prizes are paid in cash. The club keeps certain records in relation to machines and prizes. Players must cooperate with the Club regarding the keeping of those records.
34. If the Club offers any machine which is operated as part of an inter-club linked gaming system (no matter what that system is named) then -
  - (a) to the maximum extent permitted by law, progressive jackpots (and other similar prizes) are payable by TAB limited or other operator of the linked gaming system alone and the Club has no liability to pay, and gives no representation or warranty concerning, any such jackpot, prize or other benefit offered by that operator.
  - (b) any other specific Conditions applicable to the relevant linked gaming system, including those notified by the operator of the linked gaming system, apply. If there is any inconsistency, then as between you and the Club (except as any other Conditions promulgated by the Club may expressly provide) these Conditions prevail to the extent of the inconsistency to maximum extent permissible at law;
  - (c) the Club may if it chooses act as the representative or agent of the linked gaming system operator eg. to facilitate payment of a progressive jackpot or prize. However, that does not waive or affect these conditions all of which continue to apply.
35. The Club may immediately withdraw a machine or any progressive system from play if the Club in its absolute discretion suspects a malfunction. If the machine is of a progressive type then the Club will have the machine repaired as soon as practicable.
36. Only the actual prizewinner may claim or receive payment of a prize. They must do so in person at the club's premises. The Club may in its absolute discretion waive this condition.
37. If the Club in good faith pays or awards a prize to someone appearing to the club to be or to duly represent the prizewinner, then the maximum extent permitted by law that payment or award fully discharges the club from all liability to the prizewinner in relation to that prize.
38. If the Club provides any gaming machine ticket (as defined in the Gaming Machine Regulation 2002 as may be amended from time to time) then -
  - (a) The ticket may only be redeemed at the place or places at the Club's premises which are designated by the Club.
  - (b) The ticket may be redeemed at the Club's election in cash or by cheque or both.
  - (c) The Club may refuse to redeem the ticket if the Club is not satisfied that the person claiming in respect of the ticket or if that person does not provide documentary proof of identity and their signature and provide and let the Club take from that documentary proof of identity the following information - their full name and address; the identifying numbers or letters of the document proving their identity; and the full name, address and signature of the person claiming in respect of the ticket (if different to the person presenting the ticket).
  - (d) Claims may be made for unclaimed tickets at any time when the Club is open for trading.
39. The Club may still publish information relating to the type or value of any prize won and the venue or geographic location where it was won, even if the prizewinner requests in writing that nothing disclosing the prizewinner's identity be published.
40. By accepting or redeeming a prize, a prizewinner consents to use of their name and likeness for marketing purposes (until they request the Club in writing given to the Club or an employee of the Club that anything disclosing their identity not be published), based on the winning of the prize and without additional compensation.
41. Nothing in these Conditions affects anything contained in any self-exclusion deed which you may sign. The Club is entitled to rely on every provision in any self-exclusion deed signed by you (whether or not the deed is titled as a self-exclusion deed), despite anything in these Conditions.
42. Any other specific Conditions applicable to any particular machine, promotion or prize apply. If there is any inconsistency, then (except as those other conditions may expressly provide) these Conditions prevail to the extent of the inconsistency.
43. A member who breaches any of these Conditions is liable to disciplinary action by the Club in addition to any disqualification from claiming a prize and any other lawful penalty.
44. The Club may withdraw or amend these Conditions at any time in its absolute discretion. Any change becomes operative immediately it is displayed anywhere at the Club.

**IS GAMBLING A PROBLEM FOR YOU?**  
**G-LINE (NSW) IS A CONFIDENTIAL, ANONYMOUS & FREE COUNSELLING SERVICE**  
**FREE CALL 1800 633 635**



[www.allpride.com.au](http://www.allpride.com.au)

## Appendix 2

### Detailed list of Responsible Conduct of Gambling measures

---

---

Prepared by:



© Lawler Partners HGM Pty Ltd 2013. Reproduction or copy of this document, or part thereof is prohibited except as where expressly permitted under the Copyright Act 1968 or where written permission is provided from Lawler Partners Pty Ltd.

---



### **Responsible Conduct of Gambling**

The Applicant has instigated an extensive range of harm minimization measures, including the following:

- All employees involved in gaming related duties hold a responsible conduct of gambling qualification in an approved course;
- All prize winners receive prizes in accordance with clause 13 *Gaming Machines Regulation*;
- The prize schedule of the Applicant is operated in accordance with clause 14 *Gaming Machines Regulation*;
- The Applicant maintains certain records as per clause 18 and 19 *Gaming Machines Regulation*;
- The Applicant maintains records relating to gaming machine prizes as per clause 15 *Gaming Machines Regulation*;
- No inducements as specified in clause 48 of the *Gaming Machines Regulation* are offered by the Applicant to gamble;
- Player information brochures in relevant community languages are kept in the Venue as per clauses 22, 23 and 24 *Gaming Machines Regulation*;
- Signage containing wordage as per clauses 26,25 and 49 of the *Gaming Machines Regulation* are located in conspicuous positions in all gaming areas of the Venue;
- All jackpot link monitors are located in gaming or bar areas only;
- The identities of any prize winners are not published;
- The Applicant does not promote gambling outside the Venue, including not providing gambling signage which draws attention to the availability of gaming machines in the Venue, includes a term or expression frequently associated with gambling or relates to gambling franchise or gambling business;
- The Applicant maintains records of its player loyalty scheme in compliance with clauses 42, 43 and 44 *Gaming Machines Regulation*;
- The Applicant operates its player loyalty scheme in accordance with section 45 of the *Gaming Machines Act*, specifically provisions relating to the promotion of cash prizes over \$1,000, exchanging prizes for cash, redemption of bonus points for cash and advises of availability of player activity statements upon request;
- All gaming machines at the Venue are located in areas which do not attract members of the public who are outside the Venue or are contrary to public interest;
- The Applicant operates its gaming machine operations in accordance with the *ClubsNSW Code of Practice*;
- No minors are ever allowed access to gaming areas of the Venue;
- Strong links are maintained with established referral systems problem gambling counselling services;
- The Applicant operates the ClubSafe self-exclusion scheme in compliance with clause 47 *Gaming Machines Regulation*;
- Consumer information on the chance of winning maximum prizes and jackpots is made available in the gaming area;
- Gaming machines notices on the dangers of excessive gambling are placed in all required areas;
- Signage on the unavailability of credit facilities, both through access to credit funds via Automatic Teller Machines and through no facility at the venue;
- No cashing of third party cheques is possible;
- Clocks are clearly visible in all areas of the Venue as per clause 28 *Gaming Machines Regulation*;
- No gaming cash payments over \$2,000 are made;
- No cash prizes in gaming promotions;
- Limiting the value of prize winning cheques to \$1,000;
- Only the provision of opt-in marketing is undertaken and only as part of the Applicant's full suite of promotions;
- All direct advertising of gaming is contained within the Venue premises and is not visible outside the Venue; and
- The availability of player activity statements by players upon request is well known.



The Applicant has also implemented additional measures to ensure compliance with recent amendments to the *Gaming Machines Act 2001* and associated *Regulation*, this includes:

- No ATM in the Venue permits the dispensing of cash withdrawn from a credit account
- Any unclaimed prizes are now processed as follows:
- The Applicant places any unclaimed jackpot winning tickets not claimed within 12 months in a conspicuous area of the Venue for one month;
- Any unclaimed gaming machine tickets or jackpots not claimed during the 12 month period are now to be paid into the Community Development Fund;
- All prize winning cheques now clearly state - 'Prize winning cheque – cashing rules apply'.

## Appendix 3

### LGA Map (with Venue marked)

---

---

Prepared by:



© Lawler Partners HGM Pty Ltd 2013. Reproduction or copy of this document, or part thereof is prohibited except as where expressly permitted under the Copyright Act 1968 or where written permission is provided from Lawler Partners Pty Ltd.

---

# QUEANBEYAN INQUIRY SITES

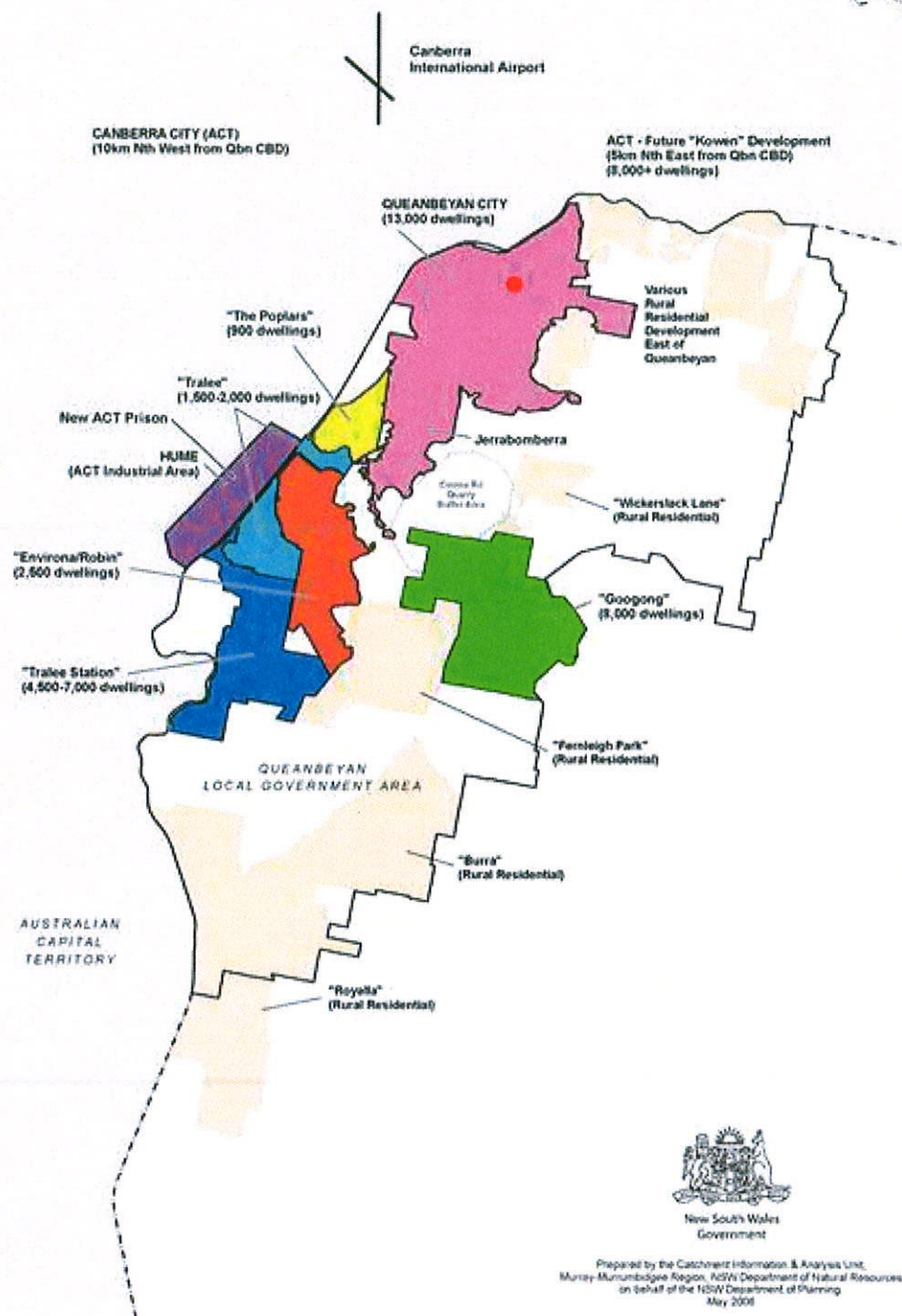

Prepared by the Catchment Information & Analysis Unit,  
Murray-Murrumbidgee Region, NSW Department of Natural Resources  
on behalf of the NSW Department of Planning  
May 2008

## Appendix 4

### Local Community Map

---

---

Prepared by:



© Lawler Partners HGM Pty Ltd 2013. Reproduction or copy of this document, or part thereof is prohibited except as where expressly permitted under the Copyright Act 1968 or where written permission is provided from Lawler Partners Pty Ltd.

---

## 5km Radius: Qeanbeyan Leagues Club

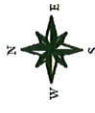

## Appendix 5

### Layout of Venue

---

---

Prepared by:



© Lawler Partners HGM Pty Ltd 2013. Reproduction or copy of this document, or part thereof is prohibited except as where expressly permitted under the Copyright Act 1968 or where written permission is provided from Lawler Partners Pty Ltd.

---

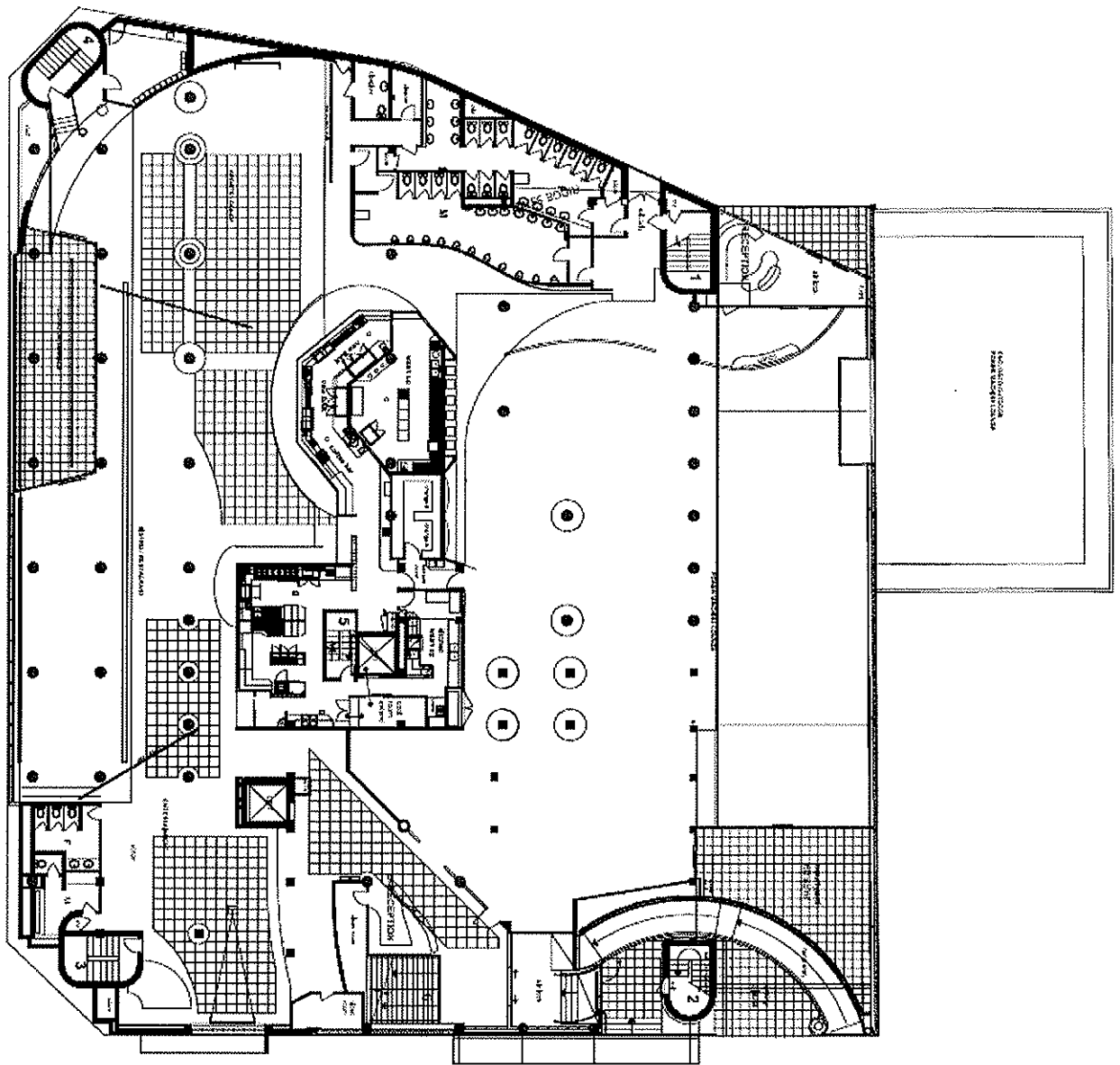



## Appendix 6

### Railway Park Skate Park

---

---

Prepared by:



© Lawler Partners HGM Pty Ltd 2013. Reproduction or copy of this document, or part thereof is prohibited except as where expressly permitted under the Copyright Act 1968 or where written permission is provided from Lawler Partners Pty Ltd.

---



TG/dh  
File No.: PF065120

14 December, 2012

Mr Jeremy Wyatt  
Manager  
Queanbeyan Leagues Club  
Monaro Street  
QUEANBEYAN NSW 2620

Dear Jeremy,

Queanbeyan City Council wishes to confirm our request for Funding for the Skate Park refurbishment and extension project, Henderson Road, Queanbeyan.

The project will involve additional hard surface with street skate features, seating and shelter, landscaping and beautification of the existing Park and family facilities.

This project is located in a rapidly growing part of Queanbeyan, subject to medium and high density housing and infill development. Queanbeyan's Community Vision 2021, identified the provision of recreational opportunities for youth as a key priority. Queanbeyan Community Strategic Plan, priority 4.5, Creating opportunities for Youth, has as an outcome 'Recreational Opportunities for Young Residents'.

Following on from Community representations regarding skate parks and recreational opportunities, Queanbeyan City Council resolution 0249/12, included, among other things, "..... include in the priority list, but not limited to, the Henderson Road Recreation and Skate area ....."

Council is seeking a contribution of \$120,000 toward these priority works and would schedule the construction for 2013 calendar year.

For more detail on the proposed works, please do not hesitate to contact me.

Yours faithfully

  
**TIM GEYER**  
MANAGER  
PARKS & RECREATION

RH:KM

22 March 2013

Southern NSW Local Health District  
PO Box 1845  
Queanbeyan NSW 2620

BY MAIL ONLY

To Whom It May Concern,

**RE: LOCAL IMPACT ASSESSMENT CLASS 1 – QUEANBEYAN LEAGUES CLUB LIMITED**

We refer to the above matter regarding a Threshold Increase Application for 20 additional gaming machines and accompanying Local Impact Assessment (LIA) Class 1 for the applicant Queanbeyan Leagues Club Limited, for the venue located at 164 Monaro Street, Queanbeyan NSW.

As per clause 36 (2) *Gaming Machines Regulation 2002* we are required to notify you that the LIA is able to be viewed on the Office of Liquor, Gaming and Racing website ([www.olgr.nsw.gov.au](http://www.olgr.nsw.gov.au)) and that you have 30 days from the date of receipt of this notice to make a submission.

Should you have any questions in relation to this matter please do not hesitate to contact the writer on 8346 6000.

Yours sincerely

**LAWLER PARTNERS HOSPITALITY**



**ROCHELLE HURST**  
Liquor & Gaming Consultant  
[rhurst@lawlerpartners.com.au](mailto:rhurst@lawlerpartners.com.au)

RH:KM

22 March 2013

Monaro LAC  
8 Farrer Place  
QUEANBEYAN NSW 2620

**BY MAIL ONLY**

To Whom It May Concern,

**RE: LOCAL IMPACT ASSESSMENT CLASS 1 – QUEANBEYAN LEAGUES CLUB LIMITED**

We refer to the above matter regarding a Threshold Increase Application for 20 additional gaming machines and accompanying Local Impact Assessment (LIA) Class 1 for the applicant Queanbeyan Leagues Club Limited, for the venue located at 164 Monaro Street, Queanbeyan NSW.

As per clause 36 (2) *Gaming Machines Regulation 2002* we are required to issue a copy of the LIA to you. Please note that if you wish to lodge a submission you have 30 days from the date of receipt of the LIA to do so. You can lodge a submission by sending it to:

Independent Liquor & Gaming Authority  
GPO Box 7060  
Sydney NSW 2001

Should you have any questions in relation to this matter please do not hesitate to contact the writer on 8346 6000.

Yours sincerely

**LAWLER PARTNERS HOSPITALITY**



**ROCHELLE HURST**  
Liquor & Gaming Consultant  
[rhurst@lawlerpartners.com.au](mailto:rhurst@lawlerpartners.com.au)

RH:KM

22 March 2013

General Manager  
Council of Social Services of NSW  
66 Albion Street  
SURRY HILLS NSW 2010

BY MAIL ONLY

To the General Manager,

**RE: LOCAL IMPACT ASSESSMENT CLASS 1 – QUEANBEYAN LEAGUES CLUB LIMITED**

We refer to the above matter regarding a Threshold Increase Application for 20 additional gaming machines and accompanying Local Impact Assessment (LIA) Class 1 for the applicant Queanbeyan Leagues Club Limited, for the venue located at 164 Monaro Street, Queanbeyan NSW.

As per clause 36 (2) *Gaming Machines Regulation 2002* we are required to notify you that the LIA is able to be viewed on the Office of Liquor, Gaming and Racing website ([www.olgr.nsw.gov.au](http://www.olgr.nsw.gov.au)) and that you have 30 days from the date of receipt of this notice to make a submission.

Should you have any questions in relation to this matter please do not hesitate to contact the writer on 8346 6000.

Yours sincerely

**LAWLER PARTNERS HOSPITALITY**



**ROCHELLE HURST**  
Liquor & Gaming Consultant  
[rhurst@lawlerpartners.com.au](mailto:rhurst@lawlerpartners.com.au)

RH:KM

22 March 2013

Gamblers Anonymous  
Regional Service Office  
P.O. Box 122  
FAIRFIELD NSW 1860

BY MAIL ONLY

To Whom It May Concern,

**RE: LOCAL IMPACT ASSESSMENT CLASS 1 – QUEANBEYAN LEAGUES CLUB LIMITED**

We refer to the above matter regarding a Threshold Increase Application for 20 additional gaming machines and accompanying Local Impact Assessment (LIA) Class 1 for the applicant Queanbeyan Leagues Club Limited, for the venue located at 164 Monaro Street, Queanbeyan NSW.

As per clause 36 (2) *Gaming Machines Regulation 2002* we are required to notify you that the LIA is able to be viewed on the Office of Liquor, Gaming and Racing website ([www.olgr.nsw.gov.au](http://www.olgr.nsw.gov.au)) and that you have 30 days from the date of receipt of this notice to make a submission.

Should you have any questions in relation to this matter please do not hesitate to contact the writer on 8346 6000.

Yours sincerely

**LAWLER PARTNERS HOSPITALITY**

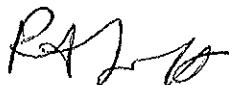

**ROCHELLE HURST**  
Liquor & Gaming Consultant  
[rhurst@lawlerpartners.com.au](mailto:rhurst@lawlerpartners.com.au)

RH:KM

22 March 2013

The General Manager  
Queanbeyan City Council  
PO Box 90  
QUEANBEYAN NSW 2620

BY MAIL ONLY

To the General Manager,

**RE: LOCAL IMPACT ASSESSMENT CLASS 1 – QUEANBEYAN LEAGUES CLUB LIMITED**

We refer to the above matter regarding a Threshold Increase Application for 20 additional gaming machines and accompanying Local Impact Assessment (LIA) Class 1 for the applicant Queanbeyan Leagues Club Limited, for the venue located at 164 Monaro Street, Queanbeyan NSW.

As per clause 36 (2) *Gaming Machines Regulation 2002* we are required to issue a copy of the LIA to you. Please note that if you wish to lodge a submission you have 30 days from the date of receipt of the LIA to do so. You can lodge a submission by sending it to:

Independent Liquor & Gaming Authority  
GPO Box 7060  
Sydney NSW 2001

Should you have any questions in relation to this matter please do not hesitate to contact the writer on 8346 6000.

Yours sincerely

**LAWLER PARTNERS HOSPITALITY**



**ROCHELLE HURST**  
Liquor & Gaming Consultant  
[rhurst@lawlerpartners.com.au](mailto:rhurst@lawlerpartners.com.au)



RH:KM

22 March 2013

Anglicare Canberra and Goulburn  
130 Cowper Street  
GOULBURN NSW 2580

BY MAIL ONLY

To Whom It May Concern,

**RE: LOCAL IMPACT ASSESSMENT CLASS 1 – QUEANBEYAN LEAGUES CLUB LIMITED**

We refer to the above matter regarding a Threshold Increase Application for 20 additional gaming machines and accompanying Local Impact Assessment (LIA) Class 1 for the applicant Queanbeyan Leagues Club Limited, for the venue located at 164 Monaro Street, Queanbeyan NSW.

As per clause 36 (2) *Gaming Machines Regulation 2002* we are required to notify you that the LIA is able to be viewed on the Office of Liquor, Gaming and Racing website ([www.olgr.nsw.gov.au](http://www.olgr.nsw.gov.au)) and that you have 30 days from the date of receipt of this notice to make a submission.

Should you have any questions in relation to this matter please do not hesitate to contact the writer on 8346 6000.

Yours sincerely

**LAWLER PARTNERS HOSPITALITY**



**ROCHELLE HURST**  
Liquor & Gaming Consultant  
[rhurst@lawlerpartners.com.au](mailto:rhurst@lawlerpartners.com.au)