

Class 1
Local Impact Assessment

Settlers Inn Hotel
101 Hastings River Drive
Port Macquarie NSW 2444

Licence Number: LIQH400123183
LGA: Port Macquarie - Hastings

1. Executive Summary

- 1.1. The applicant submits a Class 1 Local Impact Assessment ("LIA") in support of an application under the *Gaming Machines Act 2001* ("the Act") for a low-range increase to the gaming machine threshold with an increase of four (4) gaming machines for the Settlers Inn Hotel (the "Hotel")
- 1.2. The threshold increase of four (4) gaming machines would bring the overall total of the threshold to twenty five (25).
- 1.3. The subject premises is situated at 101 Hastings River Drive Port Macquarie NSW 2444.
- 1.4. The hotel is located within the Band 2 Local Government Area ("LGA") of Port Macquarie - Hastings.
- 1.5. The Act requires the Authority to be satisfied of the following in order to approve the subject gaming machine threshold increase application.
 - (a) The LIA complies with the Act & Regulation requirements;
 - (b) The LIA has demonstrated that gambling activities will be conducted in a responsible manner;
 - (c) The proposed increase in the gaming machine threshold will provide a positive contribution towards the local community; and
 - (d) The LIA has adequately addressed any community concerns arising out of the consultation.

It is submitted that the Authority would be so satisfied.

2. Hotel Background

- 2.1. The premises are located at 101 Hastings River Drive, Port Macquarie NSW 2444.
- 2.2. The primary purpose of the Hotel will be for the sale of liquor by retail. The keeping and operation of gaming machines at the Hotel will not detract unduly from the character of the Hotel being within a discrete gaming room or from the enjoyment of persons using the Hotel otherwise than for the purpose of gaming. The Hotel currently operates 21 gaming machine entitlements.
- 2.3. The Hotel provides a full range of facilities for its patrons, including large bistro, bottle shop, sports bar, function facilities, TAB, alfresco childrens' playground, Keno and gaming room as per photographs attached. Light entertainment is provided, trivia, karaoke, duos and soloists. It has car parking for 125, and 6 accommodation rooms.
- 2.4. The Hotel's current total internal floor space is substantially in excess of 400 square metres.
- 2.5. Attachment "A" depicts the existing floor plan with the proposed layout of the additional gaming machines inserted.
- 2.6. The hotel has 35 employees, full, part time and casual, thus providing significant local employment.

3. Responsible Gaming and Harm Minimisation

- 3.1. The Hotel's management and staff will be supportive of and encourage responsible gaming practices. All members of staff engaged in the operation of gaming machines have completed the prescribed *Responsible Conduct of Gambling Course*. A register of the RCG certificates and competency cards of all staff will be maintained at the Hotel.
- 3.2. The Hotel currently has 21 gaming machines. All gaming machines will be located within a gaming room as prescribed by Clause 9 of the Gaming Machines Regulation 2002, in that:-
 - (a) The gaming room is located in a bar area of the Hotel,
 - (b) The gaming room is physically separated from the general bar area by walls and doors,
 - (c) Patrons are not compelled to pass through the gaming room in order to enter or leave the Hotel or in order to gain access to another part of the Hotel,
 - (d) Entry to the gaming room is free of charge,
 - (e) The machines cannot be seen from any place outside the Hotel that is used by the public or to which the public has access,
 - (f) All gaming machines are suitably spaced in order to facilitate access,
 - (g) The gaming room is supervised at all times by way of electronic means and physical presence of the licensee or an employee,
 - (h) The gaming room has two (2) doorways that provide reasonable access to and from the gaming room to at least one operating bar and at least one toilet for each gender without the need for patrons to go on a public street, or to any area not forming part of the Hotel when moving from the gaming room to other facilities, and

- (i) The gaming room cannot be accessed directly from a public street.
- 3.3. The Hotel gaming shutdown period is 4am to 10am daily and it trades 10am to midnight Monday to Saturday and 10am to 10pm Sunday.
- 3.4. The Hotel will maintain an active membership of the Australian Hotels Association (AHA) New South Wales and will continue to support its practices and procedures for gaming harm minimisation, and the principal of the owner if the President of the Local Liquor Accord.
- 3.5. Patrons of the Hotel will be made aware of the AHA's counselling services and of the government funded "gambling HELP" counselling service.
- 3.6. Patrons will be made aware of the chances of winning and the problems associated with excessive gambling through prescribed signage required to be located on each gaming machine and throughout the gaming room by way of the prescribed notices on display.
- 3.7. The ATMs located within the Hotel also display the appropriate signage to notify patrons of the problems associated with gambling.
- 3.8. The Hotel does not offer prizes associated with the use of its gaming machines and the Hotel has a policy of not cashing cheques.
- 3.9. The Hotel will comply with advertising requirements in respect to gaming:-
 - (a) The Hotel will not use the word "casino" in any description or promotion of the Hotel,
 - (b) The Hotel will not permit gaming related advertising material to be displayed on the exterior of the premises,
 - (c) The Hotel will not promote irresponsible gaming or gaming practices,
 - (d) The Hotel will display a clock, that is set to, or within 10 minutes of, the correct time and is in view of patrons in the gaming room,
 - (e) The Hotel will not publish the details of any person who has won a prize in excess of \$1,000, and
 - (f) The Hotel will display the prescribed signage in the gaming room, on all gaming machines, and on the ATM or any EFTPOS facilities.
- 3.10. The Hotel provides gaming related help line pamphlets and has signage located throughout the hotel.
- 3.11. The Hotel managers will be highly trained to watch for problem gamblers and talk regularly to patrons, assisting patrons when required.
- 3.12. The Hotel implements the AHA's Game Care problem gaming counselling and self exclusion scheme and gaming code of conduct and is a member of the Local Liquor Accord.

4. Local Community

- 4.1. The Hotel would be described as a hotel for "locals" supplemented by tourists at holiday time.
- 4.2. The Hotel is a very prominent meeting place in Port Macquarie and the facilities are vital to the "locals". Sporting and social groups such as those listed on attachment "B" use the premises and consider the modern facilities an important asset to the community.

If the application is approved, the hotel will be able to continue to support the many organisations currently supported and to offer the same support to other local organisations not already supported.

- 4.3. The Hotel already makes substantial contributions to the local community as exemplified by the attached list of 2016-2017 community contributions (attachment "B"), supporting various local organisations, and it is hoped these can be increased.
- 4.4. For the purpose of this application the local community has been identified as the Port Macquarie - Hastings L.G.A.
- 4.5. The hotel was purchased by its present owner some 2 years ago. It was a "tired" hotel, with a poor reputation, with no sponsored teams, zero community engagement and support from the local community.

From this low base, it has been transformed, and in 2017 was voted by the NSW AHA as the best Community Hotel and is in the Australian final. It is proud to be represented by 2000 adults and 1500 children from 23 different sporting clubs as part of an extensive sports sponsorship programme. The hotel provides an environment where they and locals can develop their club cultures and success.

The hotel provides junior sporting merit awards, opens its facilities to mothers' groups in quieter morning times who use the playground and kids TV room, and provides free school holiday activities. There is free use of function rooms for groups' committee meetings, presentations nights and other gatherings, averaging 10 such per week. It provides a free courtesy bus service, and late night shuttle, not necessarily for its own patron.

5. Demography

- 5.1. The population of Port Macquarie - Hastings LGA in the 2011 Census was 72,696 and the 2016 Census was 78,539. Tourism Research Australia's latest visitors' study estimates in 2017/17 there were 1.57 million visitations to the area.
- 5.2. Port Macquarie - Hastings LGA scored 957 in the 2011 SEIFA index of relative socio-economic Advantage and Disadvantage. This hotel already provides an important social outlet for the local community, not otherwise available, and it is sought to continue and improve the facilities for, and contributions to the local community.

6. Positive Contribution to the Local Community

The applicant proposes to make a donation totalling \$45,000 to the Port Macquarie Hastings domestic and family violence specialist services. See attachment "C".

In addition, the Hotel will continue to support the local community with increased donations as exemplified in attachment "B".

7. Negative Effects

- 7.1. There may be some intangible negative impacts created as a result of an increase to the gaming machine threshold in relation to problem gambling.
- 7.2. The Hotel proposes to make a financial contribution in the sum of \$45,000 to the funding of an organisation that provide support to people dealing with social and

health problems, therefore offsetting any potential negative impacts that could arise from the approval.

- 7.3. The positive contributions will benefit the local community and the operators will continue to review and implement new responsible gaming and harm minimisation strategies in order to negate any negative impacts on the local community.

8. Conclusion

- 8.1. It is submitted that the foregoing information complies with the guidelines for a Class 1 Local Impact Assessment attaching to an application for an increase in the gaming machine threshold of the Hotel by addressing the responsible gaming and harm minimisation measures taken by the Hotel; identifies the local community of the Hotel; and provides information to show that a positive contribution will be made to the local community if the LIA and increase application are approved.
- 8.2. Approval of the gaming machines threshold to twenty four (24) will result in a direct positive impact by way of financial support and contributions to local organisations to the sum of \$45,000.
- 8.3. Based on the foregoing information and as the Hotel is located in a Band 2 Local Government Area and the application is for a low-range increase in the gaming machine threshold, we submit that there are more positive impacts for the community if the threshold application is approved than any negative impact by the installation of an additional four (4) gaming machines within the local government area. In addition, the installation of four (4) gaming machines at the Hotel will also reduce the overall number of gaming machines state-wide due to the forfeiture provisions.

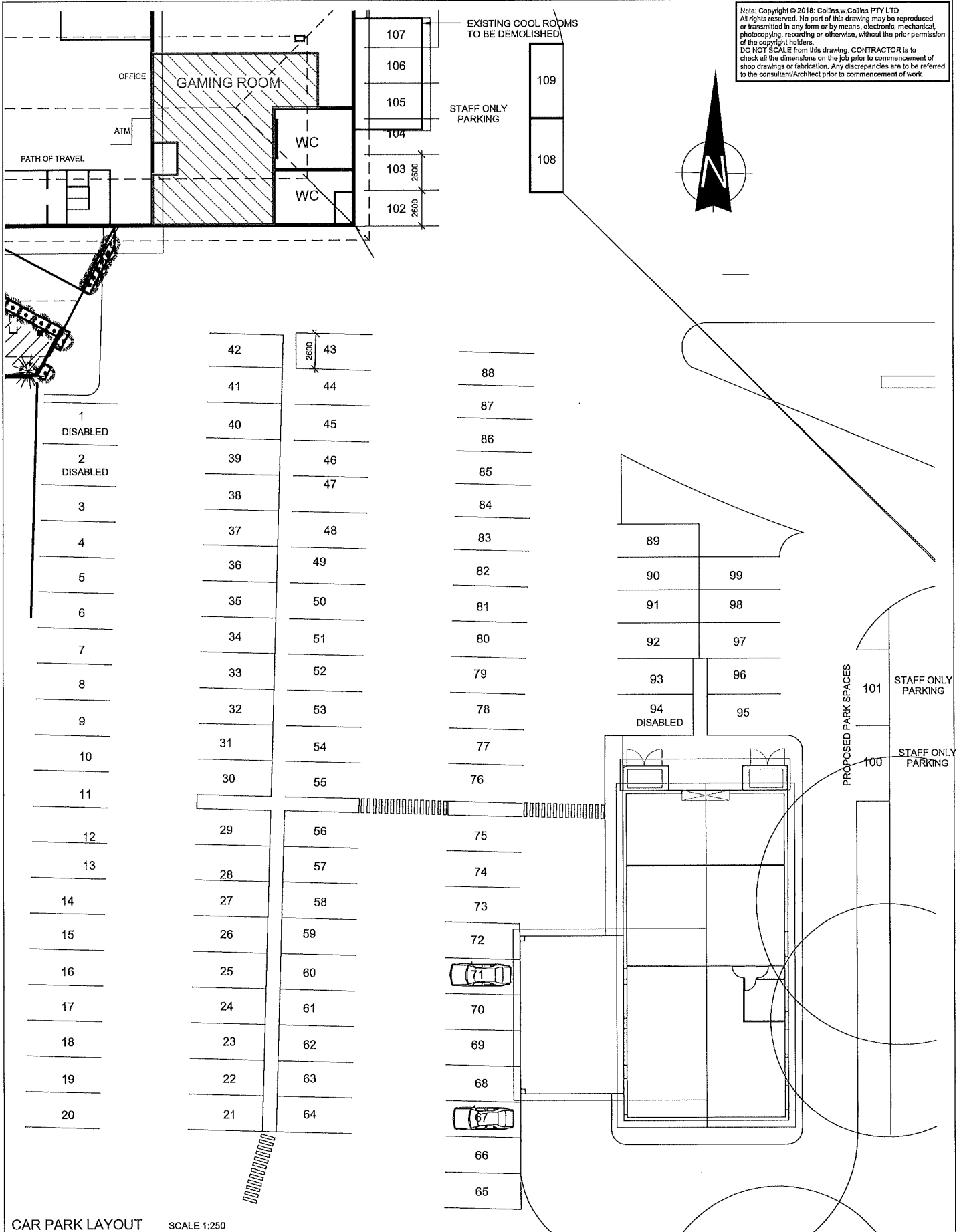

CAR PARK LAYOUT SCALE 1:250

Note: Copyright © 2018: Collins w.Collins PTY LTD
 All rights reserved. No part of this drawing may be reproduced or transmitted in any form or by means, electronic, mechanical, photocopying, recording or otherwise, without the prior permission of the copyright holders.
 DO NOT SCALE from this drawing. CONTRACTOR is to check all the dimensions on the job prior to commencement of shop drawings or fabrication. Any discrepancies are to be referred to the consultant/Architect prior to commencement of work.

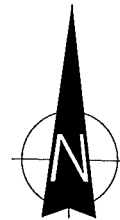
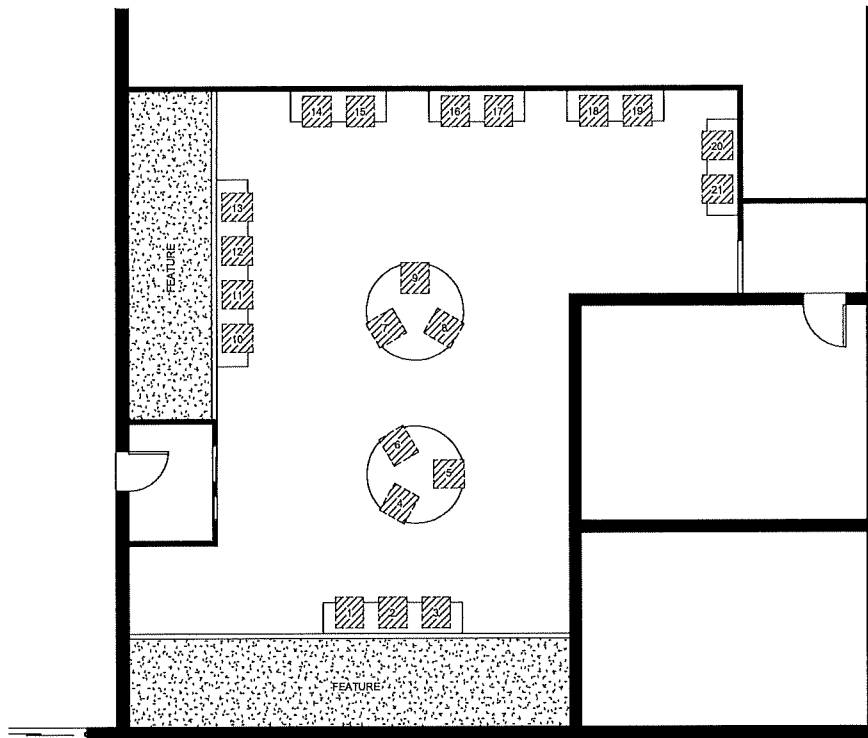

EXISTING MACHINE LAYOUT SCALE 1:100

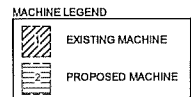
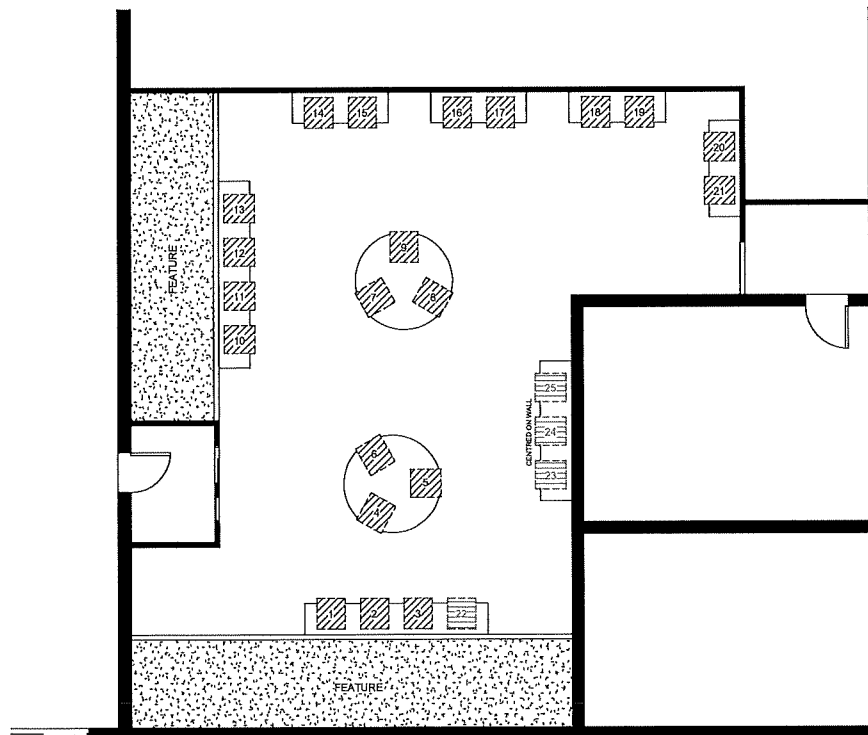

PROPOSED MACHINE LAYOUT SCALE 1:100

FUNDS COLLECTED FOR THE COMMUNITY



MONEY RAISED

Hastings Headway	\$500
Royal Flying Doctors	\$2,880
Marine Rescue	\$820
Tony Wright	\$2,000
Phil Hanley	\$2,400
Cancer Council	\$300
Port City Breakers Tour	\$1,200
Port City Breakers Raffles	\$2,888
Hastings Liquor Accord	\$400
Oz Tag Fundraiser	\$3,200
Mid North Coast Rugby Fundraiser	\$8,235
Give me 5 for Kids	\$1,100
Helgas Rugby Tour	\$3,045
Salvation Army Xmas Appeal	\$4,670
CFNSW	\$3,100
Gold Spring Memorial Keg Cup	\$700
Settlers Survivor Pirates Fundraiser	\$2,970
Westpac Helicopter	\$2,200
Cancer Council	\$32,000
Grant Cowell	\$6,788
Settlers Charity Shield	\$14,000
TOTAL	\$99,396
SPONSORSHIPS TOTAL	\$153,196



PLEASE NOTE

Last financial year (16/17) our total revenue was \$6,8377,000 up from \$1,664,000 previous financial year (15/16). All on the back of our community engagement strategy.

Cell 2017

FINANCIAL ASSISTANCE TO THE COMMUNITY

SPORT SPONSORSHIP

Hastings Valley Vikings	\$5,000
Port Pirates Cricket Club	\$7,000
Port City Breakers Rugby League Club	\$5,000
Port City Breakers Junior League Club	\$2,500
Port Macquarie Rugby Club	\$1,500
Port Macquarie Junior Rugby Club	\$2,000
Mid North Coast Rugby	\$3,000
Port Macquarie Basketball	\$5,000
Hastings Valley Pirates Baseball Club	\$1,000
Hastings baseball association	\$1,000
Port Combined Netball Club	\$500
Port Saints Netball Club	\$1,000
Hastings Valley Netball Association	\$1,000
Port United Soccer Club	\$3,000
Port Macquarie Magpies Junior AFL	\$1,000
Port Touch Association	\$2,000
Port Macquarie Oztag	\$2,000
Port Macquarie Futsal Comp	\$500
Port Macquarie Volleyball Comp	\$500
Classic Motorcycle Club	\$500
Hasting Archery Club	\$250
Boardriders Rugby League Club	\$2,000
AFL Masters mid north coast	\$500
TOTAL	\$46,750

OTHER

Tasting on the Hastings	\$3,000
If We All Had Wings	\$1,000
Port Macquarie OzHarvest	\$1,000
Big Dig Rotary Event	\$350
St Joseph Primary School	\$750
Hastings Primary School	\$100
Westport Primary School	\$500
St Columba Anglican College	\$100
St Agnes Primary School	\$250

TOTAL	\$7,050
--------------	----------------

GRAND TOTAL	\$53,800
--------------------	-----------------



07/03/2018

Who is PMH Domestic & Family Violence Specialist Service

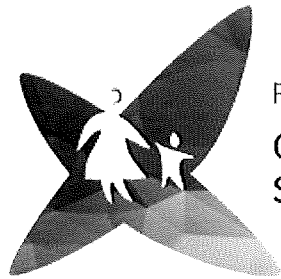

Port Macquarie Hastings
domestic&family violence
specialist service

Who is the Domestic & Family Violence Specialist Service

Service

PMH Domestic & Family Violence Specialist Service (PMH D&FV SS) was formed in 1980 as the Hastings Women and Children's Refuge Inc. to provide crisis accommodation and support to women and their children or single women escaping domestic violence or in crisis.

The Organisation provides many services through its four main service delivery streams;

- Galbaan House - Refuge crisis accommodation

- Liberty Cottage Outreach Centre

- Specialist Housing Support Project and Transitional Housing Program

- Community Partnerships Against D&FV Project

Support services may include

