

Appendix
Local Impact Assessment Class 2
Strathfield Recreation Club limited
trading as Strathfield Sports Club

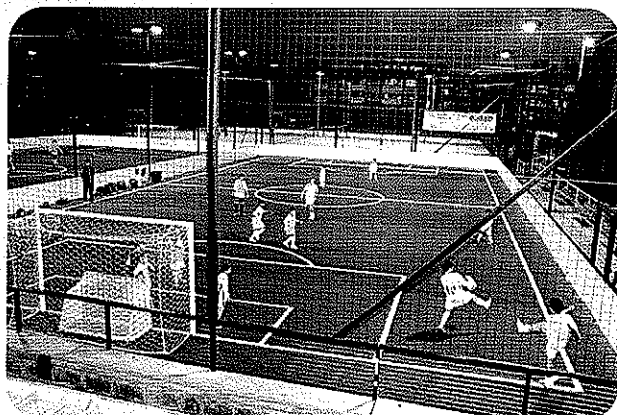

Venue Id: 230538
4a Lyons St, Strathfield NSW 2135

October 2010

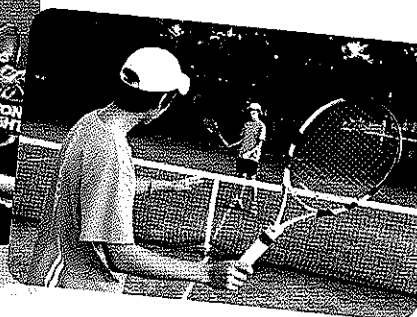
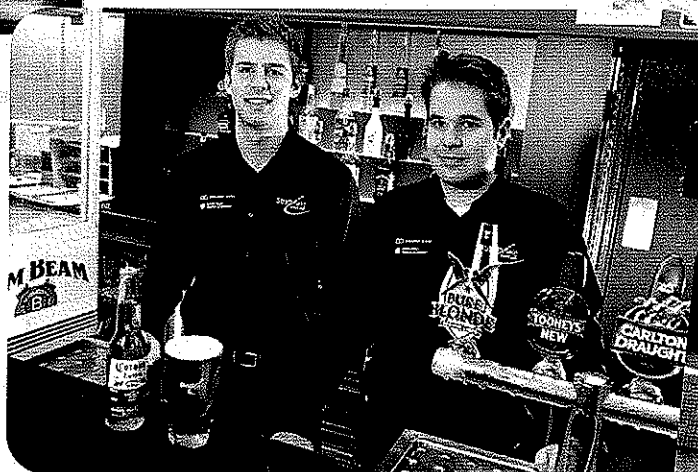

APPENDIX 1.

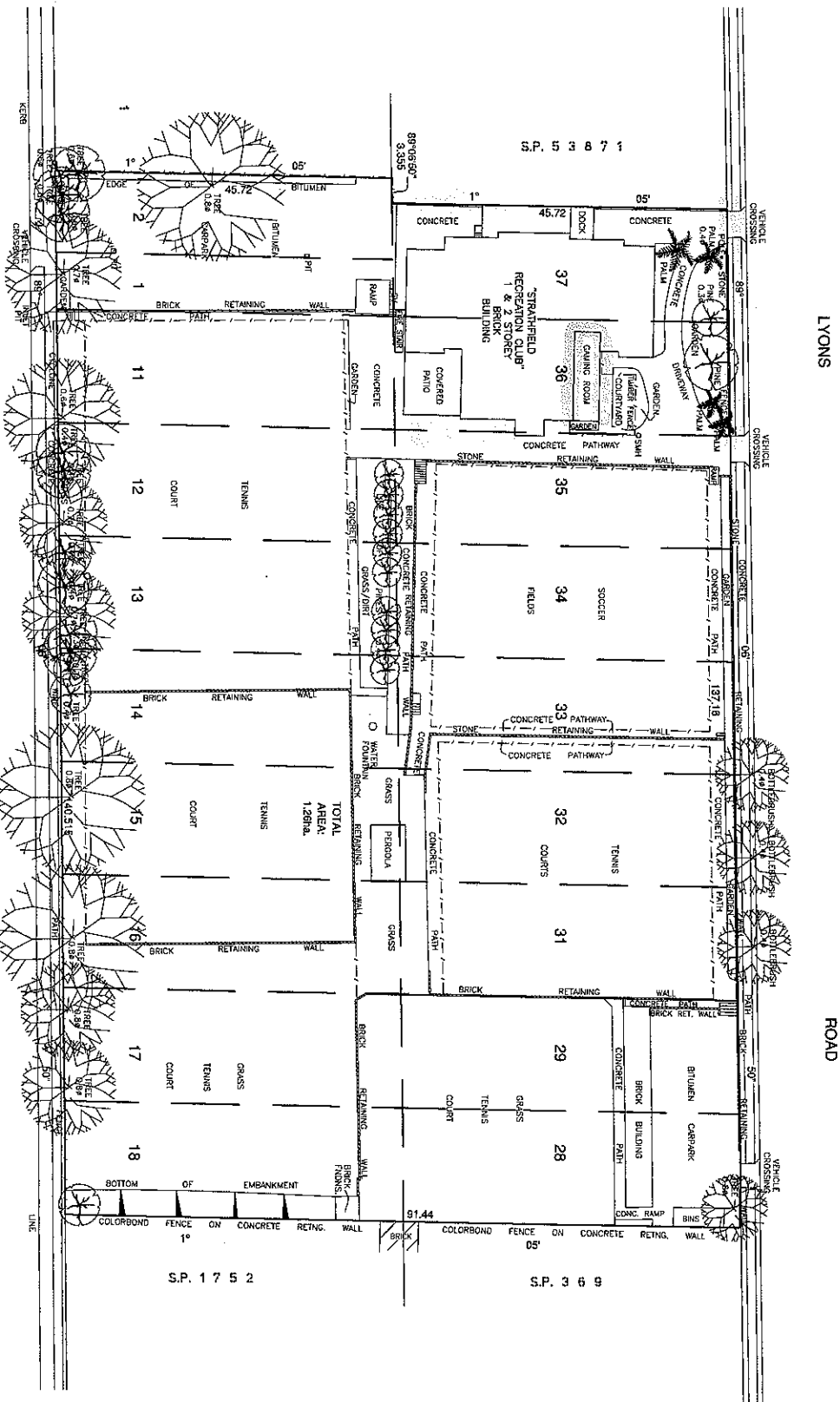

NOTES

1. GENERAL OF THE ZONING AND/OR DESIGN IS THE PROPERTY OF THE LOCAL GOVERNMENT AND IS SUBJECT TO CHANGE WITHOUT NOTICE.
2. THE RELATIONSHIP OF ADJACENT TO EQUIVALENTS IS DETERMINED BY THE LOCAL GOVERNMENT AND IS SUBJECT TO CHANGE WITHOUT NOTICE.
3. SERVICES SHOWN ARE NOT TO BE TAKEN FROM THE VEHICLE CROSSING ON THE SITE. THE RELEVANT AUTHORITY SHOULD BE CONTACTED TO DETERMINE THE LOCATION AND DEPTH OF THE SERVICES.
4. THE EVIDENCE ON THESE PLANS INDICATES THAT THE RELEVANT AUTHORITY SHOULD BE CONTACTED TO DETERMINE THE LOCATION AND DEPTH OF THE SERVICES.
5. THE RELEVANT AUTHORITY SHOULD BE CONTACTED TO DETERMINE THE LOCATION AND DEPTH OF THE SERVICES.

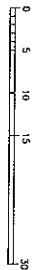

PLAN SHOWING DETAILS OVER LOTS 11-18 & 29-37, SEC. 1 N. O.P. 555, LOT 1 IN D.P. 717/55 & LOT 1 IN D.P. 555/52 AT No. 44 LYONS ROAD SUBURB, STRATHFIELD FOR STRATHFIELD RECREATION CLUB		DATE: 18/03/2010 SCALE: 1:300 (A1) DATUM: AUST. HIGH DTD ORIGIN: S.P. 369 SOURCE: S.C.L.A.S. QLR REF: 10/192	CONSULTING SURVEYORS WATSON BUCHAN P.O. BOX 178, PHONE 554033 CANNINGDALE, QLD 4070 EMAIL: info@watsonbuchan.com.au
--	--	---	---

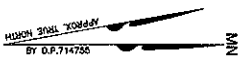

APPENDIX 3

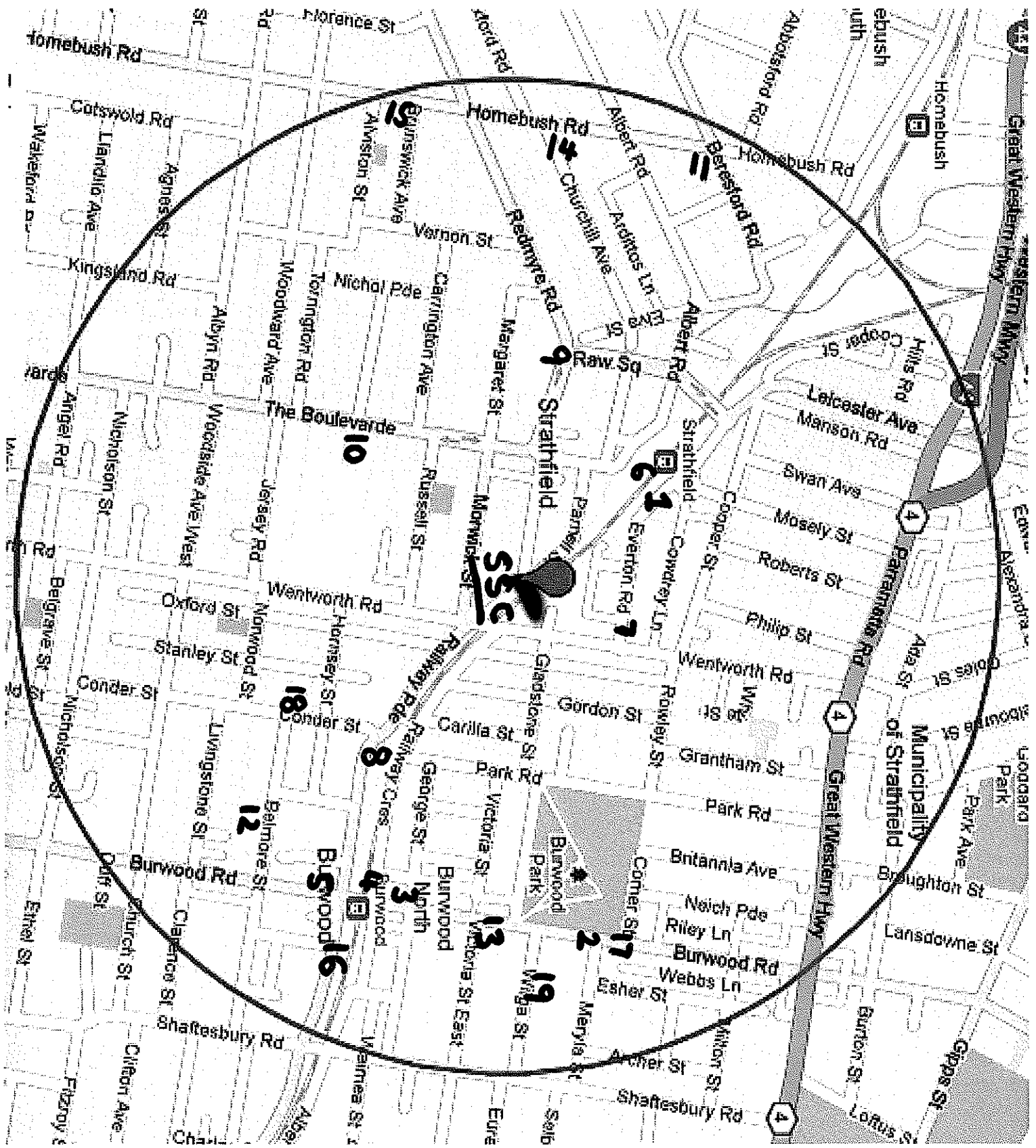

APPENDIX 4

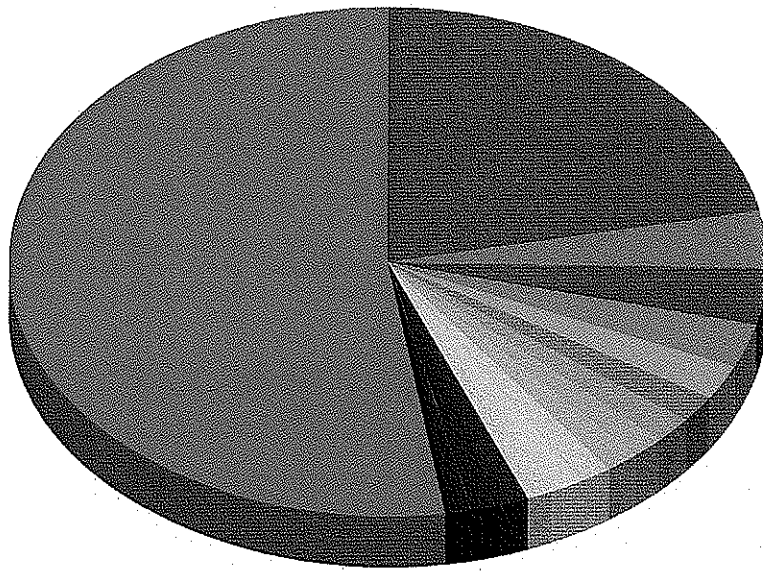

Strathfield	367	21.8%
Concord	61	3.6%
Homebush	58	3.4%
Burwood	46	2.7%
Lidcombe	37	2.2%
Croydon Park	31	1.8%
Greenacre	27	1.6%
Concord West	25	1.5%
Ashfield	23	1.4%
Belfield	22	1.3%
Campsie	22	1.3%
Drummoyne	22	1.3%
Enfield	20	1.2%
Five Dock	20	1.2%
Abbotsford	19	1.1%
Others	884	52.5%
Total:	1,684	100.0%



04th November 2010

PUBLIC NOTICE

Strathfield Sports Club Limited has submitted a local Impact Assessment Class 2 and threshold application to the Casino Liquor & Gaming Control Authority. The application is to increase our Poker Machine Gaming threshold by 20. The application can be viewed on the Office of Liquor Gaming and Racing website. www.olgr.nsw.gov.au

Any person wishing to make a submission in regards to our application may do so in writing addressed to the General Manager, Strathfield Sports Club, 4a Lyons st, Strathfield NSW 2135. Submissions close 15/12/2010

Yours Sincerely,

A handwritten signature in black ink, appearing to read "C. Dunn", with a long horizontal flourish extending to the right.

Christopher Dunn
General Manager



04th November 2010

Mike Wallace
Chief Executive Officer
Sydney South West
Area Health Service

Dear Mike,

Strathfield Sports Club Limited has submitted a local Impact Assessment Class 2 and threshold application to the Casino Liquor & Gaming Control Authority. The application is to increase our Poker Machine Gaming threshold by 20. The application can be viewed on the Office of Liquor Gaming and Racing website. www.olgr.nsw.gov.au

Any person wishing to make a submission in regards to our application may do so in writing addressed to the General Manager, Strathfield Sports Club, 4a Lyons st, Strathfield NSW 2135. Submissions close 15/12/2010

Yours Sincerely,

A handwritten signature in black ink, appearing to read "C Dunn", written over a horizontal line.

Christopher Dunn
General Manager



04th November 2010

Leading Senior Constable Strbik
Burwood Licensing
Burwood Police
214 Parramatta Rd
Burwood NSW 2134

Dear Senior Constable Strbik,

Strathfield Sports Club Limited has submitted a local Impact Assessment Class 2 and threshold application to the Casino Liquor & Gaming Control Authority. The application is to increase our Poker Machine Gaming threshold by 20. The application can be viewed on the Office of Liquor Gaming and Racing website. www.olgr.nsw.gov.au

Any person wishing to make a submission in regards to our application may do so in writing addressed to the General Manager, Strathfield Sports Club, 4a Lyons st, Strathfield NSW 2135. Submissions close 15/12/2010

Yours Sincerely,

A handwritten signature in black ink, appearing to read "C Dunn", written over a horizontal line.

Christopher Dunn
General Manager



04th November 2010

Dev Mukherjee
Senior Policy Officer
NCOSS
66 Albion Street
SURRY HILLS
NSW 2010

Dear Dev,

Strathfield Sports Club Limited has submitted a local Impact Assessment Class 2 and threshold application to the Casino Liquor & Gaming Control Authority. The application is to increase our Poker Machine Gaming threshold by 20. The application can be viewed on the Office of Liquor Gaming and Racing website. www.olgr.nsw.gov.au

Any person wishing to make a submission in regards to our application may do so in writing addressed to the General Manager, Strathfield Sports Club, 4a Lyons st, Strathfield NSW 2135. Submissions close 15/12/2010

Yours Sincerely,

A handwritten signature in black ink, appearing to read "C Dunn", written over a horizontal line.

Christopher Dunn
General Manager



04th November 2010

Mr. Michael McMahon
General Manager
Burwood Council
Po Box 240
Burwood NSW 1805

Dear Michael,

Strathfield Sports Club Limited has submitted a local Impact Assessment Class 2 and threshold application to the Casino Liquor & Gaming Control Authority. The application is to increase our Poker Machine Gaming threshold by 20. The application can be viewed on the Office of Liquor Gaming and Racing website. www.olgr.nsw.gov.au

Any person wishing to make a submission in regards to our application may do so in writing addressed to the General Manager, Strathfield Sports Club, 4a Lyons st, Strathfield NSW 2135. Submissions close 15/12/2010

Yours Sincerely,

Christopher Dunn
General Manager